

Parts List				
ITEM	QTY	ID #	DESCRIPTION	STOCK PART #
1	2	1295P2	Support Angle	068090-GALV
2	4	HN 3/8 - 16 Zinc-5	Hex Nut - Grade 5, Zinc	
3	4	HHMB 3/8-16 UNC - 1.75 Zinc -5	Hex Head Machine Bolt -Grade 5, Zinc	
4	4	FW 3/8 - Regular - Type B zinc	Flat Washer-zinc	
5	4	3/8 LW Zinc	Lock Washer, Zinc	
6	4	HHMB 3/8-16 UNC - 0.75 Zinc -5	Hex Head Machine Bolt -Grade 5, Zinc	

REVISIONS				
ZONE	REV	DESCRIPTION	DATE	BY
	A	Changed to 3/8x3/4 bolt from 1"	10-25-17	BCM

D

D

1295 Operator Mounts
to top of bracket.

#072914 Operator Mounting Column
(Sold Separately)

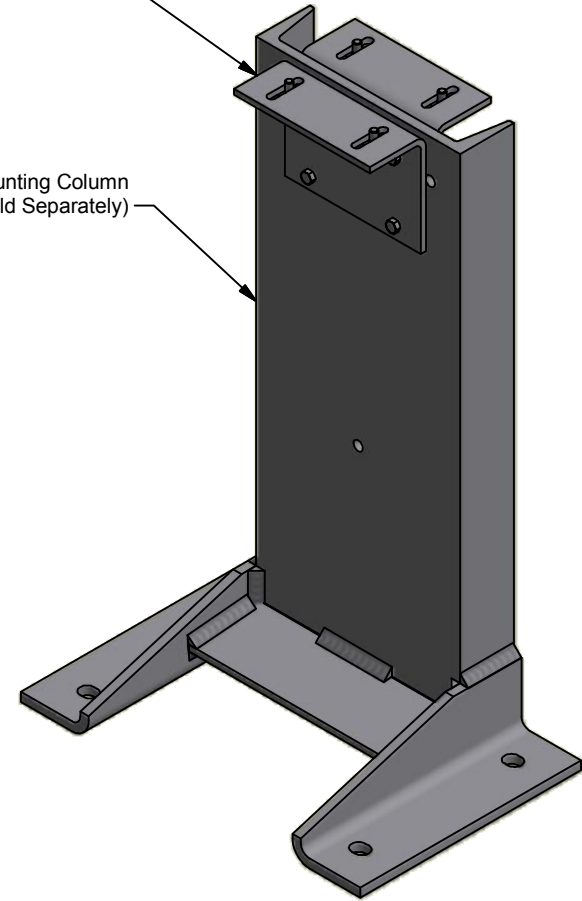
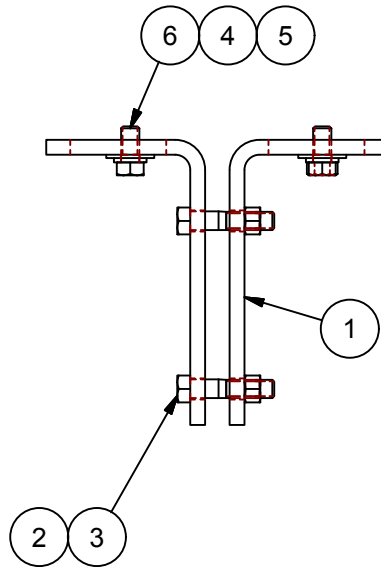
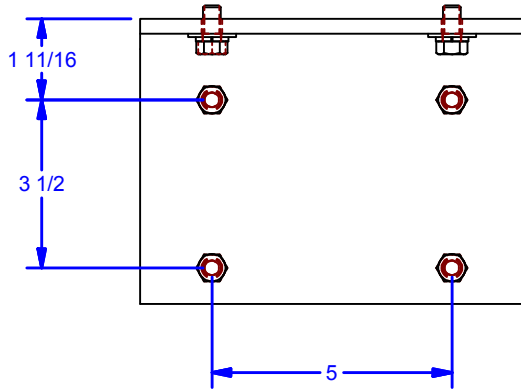

ALL DIMENSIONS IN INCHES

THE INFORMATION CONTAINED IN THIS DRAWING IS THE SOLE PROPERTY OF CROWN INDUSTRIAL. ANY REPRODUCTION IN PART OR AS A WHOLE WITHOUT THE WRITTEN PERMISSION OF CROWN INDUSTRIAL IS PROHIBITED.

DESCRIPTION:

Operator to Column Support Assembly

FINISH:

Galv

ID #:

1295P377

STOCK PART #:

1295P377

MATERIAL:

PCS:

1

REV:

A



**CROWN
INDUSTRIAL**

So. San Francisco, Ca
(650) 952-5150

www.crown-industrial.com

DWG #: 1295P371
DRAWN:BCM 10/24/2017
SHEET #2

File: 1295P371.idw

A

A

4

3

2

1

A