

4

3

2

1

Track Notches for Joint Brackets
(To join two tracks together)



Top of Track

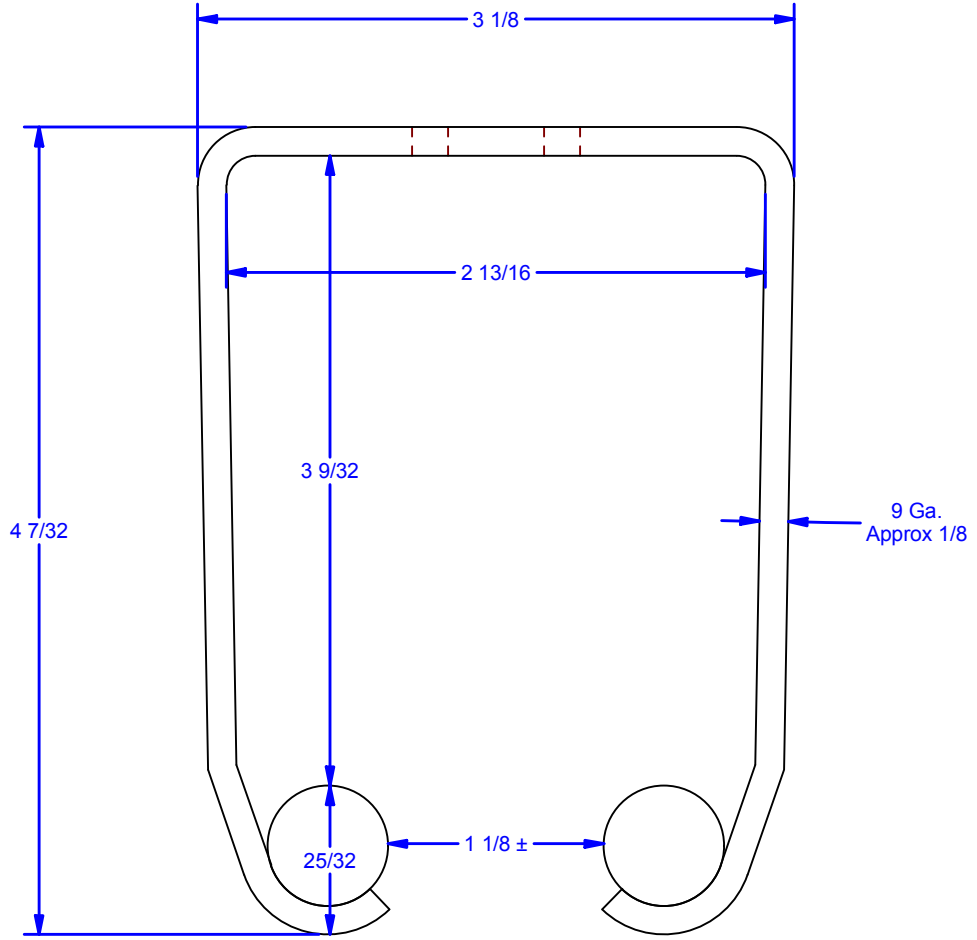

Note:
60" On Center Maximum Bracket Spacing for doors up to 2,500 lbs.
24" On Center Maximum Bracket Spacing for doors over 2,500 lbs and up to 5,000 lbs.

Available Track Lengths:
6'-0", 8'-0", 10'-0", & 12'-0"

Available Finishes:
Powder Coat Black
Powder Coat Pebble Tan
Hot Dipped Galvanized w. 5/8" Dia. 304 Stainless Steel bars

ALL DIMENSIONS IN INCHES

THE INFORMATION CONTAINED IN THIS DRAWING IS THE SOLE PROPERTY OF CROWN INDUSTRIAL. ANY REPRODUCTION IN PART OR AS A WHOLE WITHOUT THE WRITTEN PERMISSION OF CROWN INDUSTRIAL IS PROHIBITED.	ID #:	0002300-01	STOCK PART #:	25P-6
	MATERIAL:	Steel, Mild		
DESCRIPTION: #25 Box Track x 6'-0"				
FINISH:	Powdercoat Pebble Tan	# PCS:	1	REV:



CROWN INDUSTRIAL

So. San Francisco, Ca
(650) 952-5150
www.crown-industrial.com

DWG #: #25
DRAWN:BCM 12/15/2006
SHEET #10

File: 0000455.idw

4

3

2

1