

Parts List			
ITEM	QTY	DESCRIPTION	STOCK #
1	1	Cane	
2	1	524p21 Cane Retainer	
3	2	524P21 Guide Clip	
4	6	Round Head Phillips Wood Screw, Zinc	14-10 x 1-1/4
5	1	524P42 Floor Insert Sleeve for 524P21 Cane Bolt	0524.00042
6	1	Pad Lockable Assembly for 524 Cane Bolt (OPTIONAL)	0524PL-Z
7	2	Pan Head Phillips Sheet Metal Screw	1/4-14 x 1 1/4
8	1	Padlock (By Others) Max. Shackle Dia: 1/2"; Min. Vertical Clear: 1-3/4"; Min. Horz. Clear: 1"	

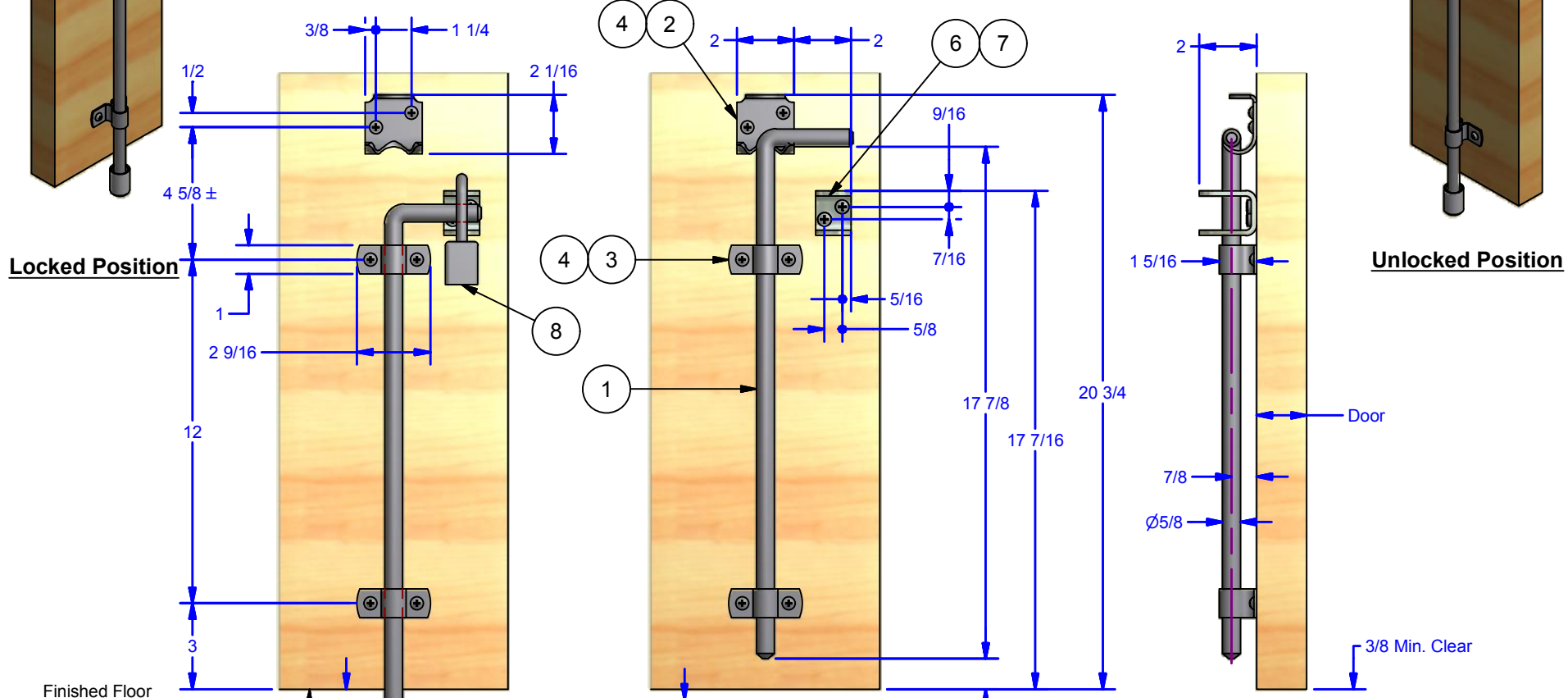
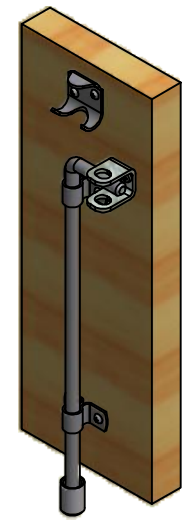
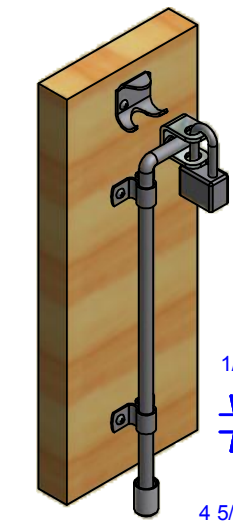

Finished Floor

Bottom of Door

Drill into Floor
*Use Ø 1" Drill

ALL DIMENSIONS IN INCHES		ID #:	STOCK PART #:
THE INFORMATION CONTAINED IN THIS DRAWING IS THE SOLE PROPERTY OF CROWN INDUSTRIAL. ANY REPRODUCTION IN PART OR AS A WHOLE WITHOUT THE WRITTEN PERMISSION OF CROWN INDUSTRIAL IS PROHIBITED.		0000478	0524.00021
DESCRIPTION:		MATERIAL:	
Cane Bolt 5/8" x 18"		Steel	
FINISH:	# PCS:	REV:	
Clear Zinc		B	

*Alternative Finish: #0524.00021BZC black zinc



CROWN INDUSTRIAL
So. San Francisco, Ca
(650) 952-5150
www.crown-industrial.com

Parts List			
ITEM	QTY	DESCRIPTION	STOCK #
1	1	Cane, S.S.	
2	1	Cane Retainer, S.S.	
3	2	Guide Clip Weldment, S.S.	
4	8	Pan Head Phillips Sheet Metal Screw (2 for Optional Pad Lock Assembly)	1/4-14 x 1 1/4
5	1	Keeper for 0524.00021 Cane Bolt-SS #2B	0524.00042-S
6	1	Pad Lockable Assembly for 524 Cane Bolt (OPTIONAL)	0524PL-S
7	1	Padlock (By Others) Max. Shackle Dia: 1/2"; Min. Vertical Clear: 1-3/4"; Min. Horz. Clear: 1"	

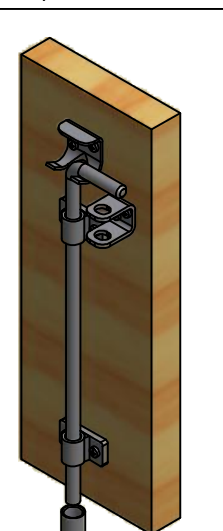
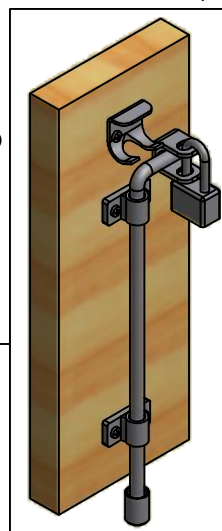

Locked Position

Unlocked Position

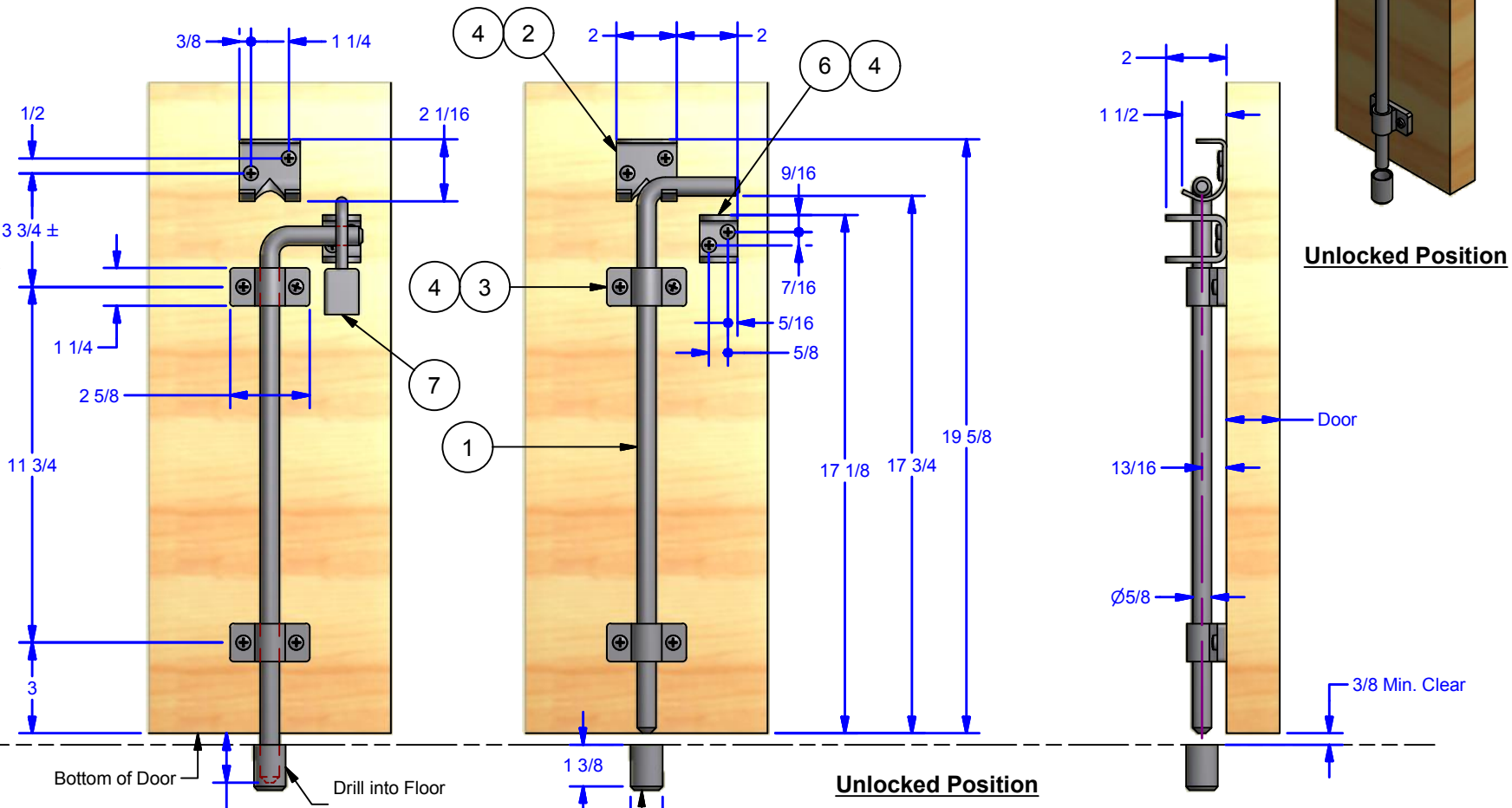

Finished Floor

Bottom of Door
 Drill into Floor
 *Use Ø 1" Drill
 1 5/8 Throw

Locked Position

Unlocked Position

ALL DIMENSIONS IN INCHES		ID #:	0001433	STOCK PART #:	0524.00021-S
THE INFORMATION CONTAINED IN THIS DRAWING IS THE SOLE PROPERTY OF CROWN INDUSTRIAL. ANY REPRODUCTION IN PART OR AS A WHOLE WITHOUT THE WRITTEN PERMISSION OF CROWN INDUSTRIAL IS PROHIBITED.					
DESCRIPTION:		MATERIAL:			
Cane Bolt 5/8" x 18", 304 Stainless Steel		304 Stainless Steel			
FINISH:		# PCS:	1	REV:	A
Brushed					



CROWN INDUSTRIAL
 So. San Francisco, Ca
 (650) 952-5150
 www.crown-industrial.com

DWG #: 524P21
 DRAWN: BCM 7/31/2015
 SHEET #5
 File: 000478.idw