

4

3

2

1

D

D

C

C

B

B

A

A

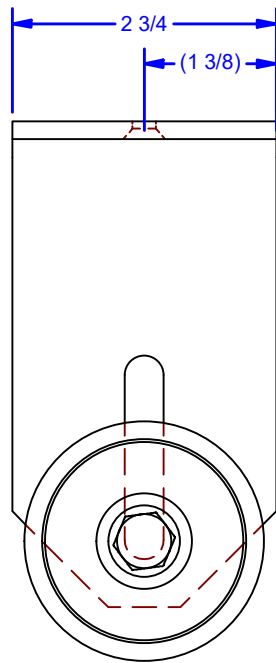

2X $\phi 1/4$ HOLES
For #12 FLAT HEAD WOOD SCREW

White Nylon Wheel

2X $\phi 1/4$ HOLES
For #12 FLAT HEAD WOOD SCREW

For #12 FLAT HEAD WOOD SCREW

For #12 FLAT HEAD WOOD SCREW

For #12 FLAT HEAD WOOD SCREW

For #12 FLAT HEAD WOOD SCREW

For #12 FLAT HEAD WOOD SCREW

For #12 FLAT HEAD WOOD SCREW

For #12 FLAT HEAD WOOD SCREW

For #12 FLAT HEAD WOOD SCREW

For #12 FLAT HEAD WOOD SCREW

For #12 FLAT HEAD WOOD SCREW

For #12 FLAT HEAD WOOD SCREW

For #12 FLAT HEAD WOOD SCREW

For #12 FLAT HEAD WOOD SCREW

For #12 FLAT HEAD WOOD SCREW

For #12 FLAT HEAD WOOD SCREW

For #12 FLAT HEAD WOOD SCREW

For #12 FLAT HEAD WOOD SCREW

For #12 FLAT HEAD WOOD SCREW

For #12 FLAT HEAD WOOD SCREW

For #12 FLAT HEAD WOOD SCREW

For #12 FLAT HEAD WOOD SCREW

For #12 FLAT HEAD WOOD SCREW

For #12 FLAT HEAD WOOD SCREW

For #12 FLAT HEAD WOOD SCREW

For #12 FLAT HEAD WOOD SCREW

For #12 FLAT HEAD WOOD SCREW

For #12 FLAT HEAD WOOD SCREW

For #12 FLAT HEAD WOOD SCREW

For #12 FLAT HEAD WOOD SCREW

For #12 FLAT HEAD WOOD SCREW

For #12 FLAT HEAD WOOD SCREW

For #12 FLAT HEAD WOOD SCREW

For #12 FLAT HEAD WOOD SCREW

For #12 FLAT HEAD WOOD SCREW

For #12 FLAT HEAD WOOD SCREW

For #12 FLAT HEAD WOOD SCREW

For #12 FLAT HEAD WOOD SCREW

For #12 FLAT HEAD WOOD SCREW

For #12 FLAT HEAD WOOD SCREW

For #12 FLAT HEAD WOOD SCREW

For #12 FLAT HEAD WOOD SCREW

For #12 FLAT HEAD WOOD SCREW

For #12 FLAT HEAD WOOD SCREW

For #12 FLAT HEAD WOOD SCREW

For #12 FLAT HEAD WOOD SCREW

For #12 FLAT HEAD WOOD SCREW

For #12 FLAT HEAD WOOD SCREW

For #12 FLAT HEAD WOOD SCREW

For #12 FLAT HEAD WOOD SCREW

For #12 FLAT HEAD WOOD SCREW

For #12 FLAT HEAD WOOD SCREW

For #12 FLAT HEAD WOOD SCREW

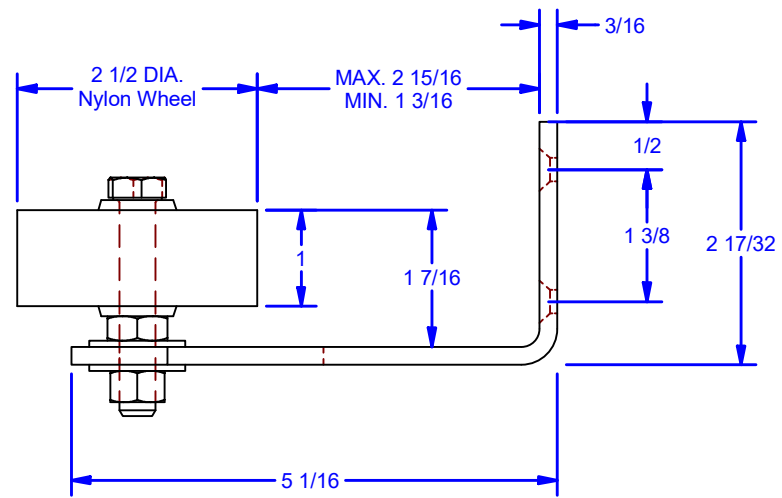

ALL DIMENSIONS IN INCHES

| | | | | |
|--|-----------|---------------------|---------------|----------------|
| THE INFORMATION CONTAINED IN THIS DRAWING IS THE SOLE PROPERTY OF CROWN INDUSTRIAL. ANY REPRODUCTION IN PART OR AS A WHOLE WITHOUT THE WRITTEN PERMISSION OF CROWN INDUSTRIAL IS PROHIBITED. | ID #: | 0000633 | STOCK PART #: | 0058.00002SS-W |
| | MATERIAL: | 304 Stainless Steel | | |
| DESCRIPTION: 58P2 Wall Mounted Stay Roller For 1-1/2" to 2-3/4" Thick Door | | | | |
| FINISH: | Mill Fin. | # PCS: | REV: | A |



CROWN INDUSTRIAL

So. San Francisco, Ca
(650) 952-5150

www.crown-industrial.com

DWG #: 58P2
DRAWN:BCM 8/18/2009
SHEET #2

File: 0000631.idw

4

3

2

1



1