

4

3

2

1

D

D

C

C

B

B

A

A

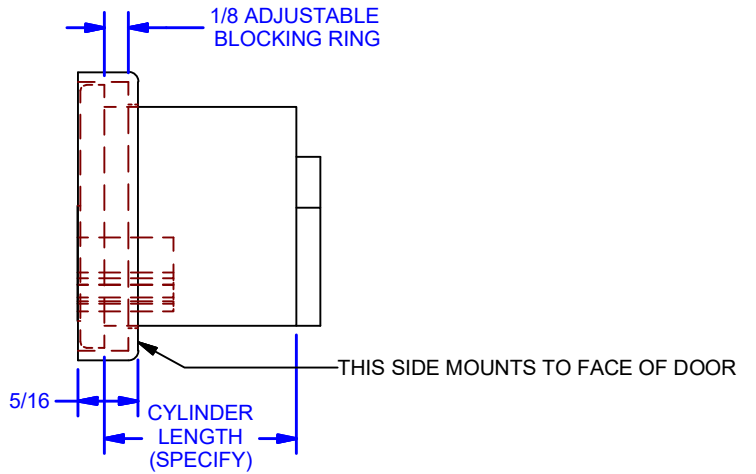
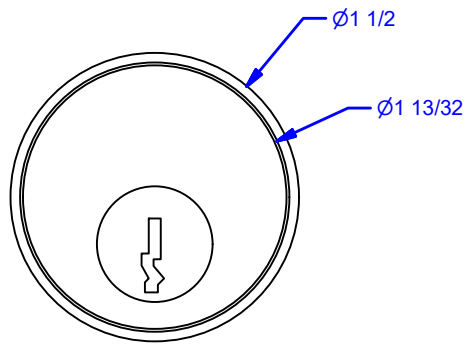
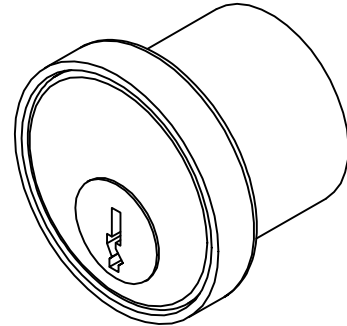
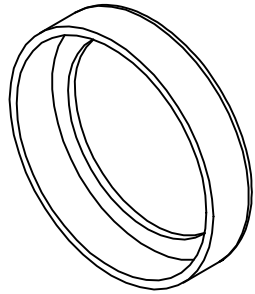

DWG #: 1850
 DRAWN:BCM 10/26/2011
 SHEET #14
 File: 0000184.idw

ALL DIMENSIONS IN INCHES

THE INFORMATION CONTAINED IN THIS DRAWING IS THE SOLE PROPERTY OF CROWN INDUSTRIAL. ANY REPRODUCTION IN PART OR AS A WHOLE WITHOUT THE WRITTEN PERMISSION OF CROWN INDUSTRIAL IS PROHIBITED.	ID #:	0001166	STOCK PART #:	CTR-26D
	MATERIAL:			
DESCRIPTION: Compression Trim Ring & Spring w/ Cylinder				
FINISH:	# PCS:	1	REV:	



CROWN INDUSTRIAL
 So. San Francisco, Ca
 (650) 952-5150
 www.crown-industrial.com

4

3

2

1

