

4

3

2

1

Parts List

ITEM	QTY	PART #	DESCRIPTION
1	1	0001222-36	Cremona Bolt Center Spacer x 36"
2	1	0001734	Rod Guide Assembly
3	1	3/4 - 10HCN1 1/8x2 1/4Zinc-	Hex Coupling Nut
4	2	HN 1/2 - 13 Zinc-5	Hex Nut - Grade 5, Zinc
5	2	HHCS 1/2-13 UNC - 2.75 Zinc-5	Hex Head Cap Screw - Grade 5, Zinc
6	2	HHCS 1/2-13 UNC - 3.5 Zinc-5	Hex Head Cap Screw - Grade 5, Zinc

36

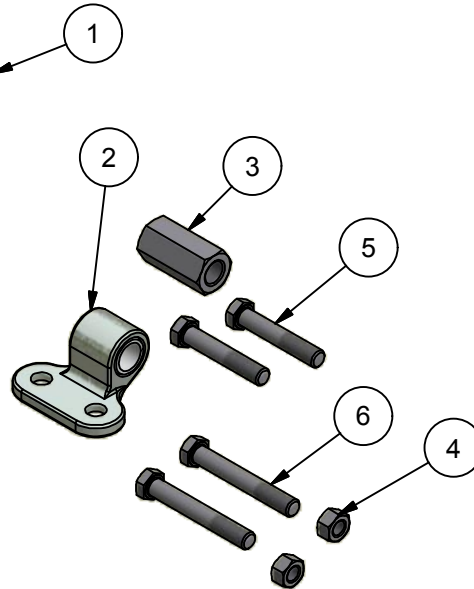

ALL DIMENSIONS IN INCHES

THE INFORMATION CONTAINED IN THIS DRAWING IS THE SOLE PROPERTY OF CROWN INDUSTRIAL. ANY REPRODUCTION IN PART OR AS A WHOLE WITHOUT THE WRITTEN PERMISSION OF CROWN INDUSTRIAL IS PROHIBITED.	ID #:	0001985	STOCK PART #:	1028.00370
	MATERIAL:			
DESCRIPTION: Cremona Bolt 3' Add-on Package				
FINISH:			# PCS:	1
			REV:	



CROWN INDUSTRIAL

So. San Francisco, Ca
(650) 952-5150

www.crown-industrial.com

DWG #: 0001706
DRAWN:BCM 5/5/2015
SHEET #32

File: 0001706.idw

4

3

2

1

D

C

B

A

D

C

B

A