

4

3

2

1

D

D

C

C

B

B

A

A

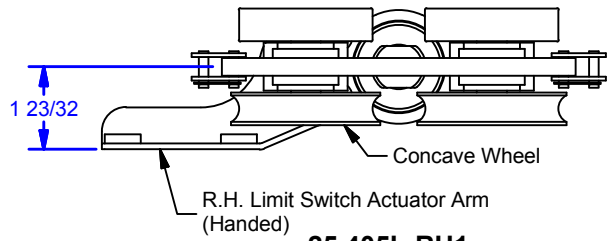

**25.405L-RH1**

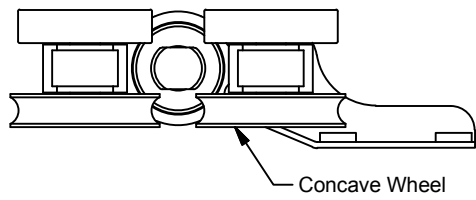

**25.405L-LH2**

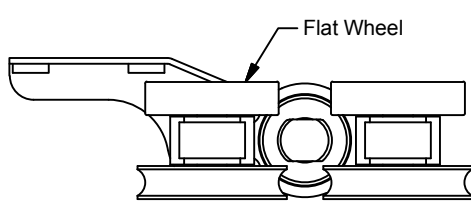

**25.405L-RH3**

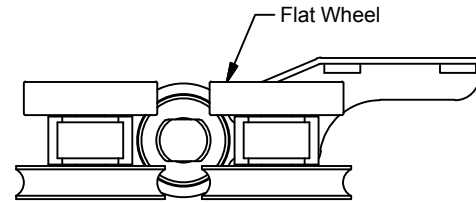

**25.405L-LH4**

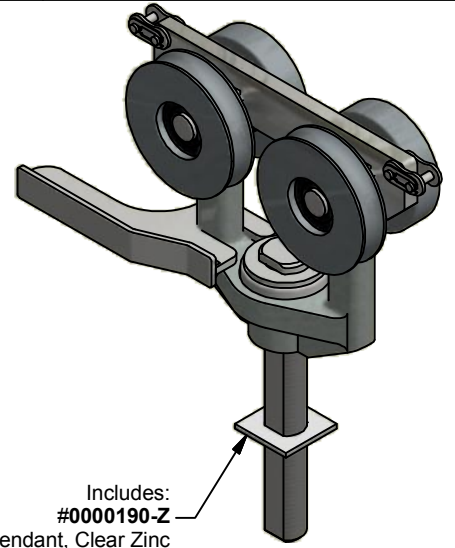

Includes:  
#0000190-Z  
7/8" Sq. Flat Keeper for Flat Pendant, Clear Zinc

7/8" Sq. Flat Keeper for Flat Pendant, Clear Zinc

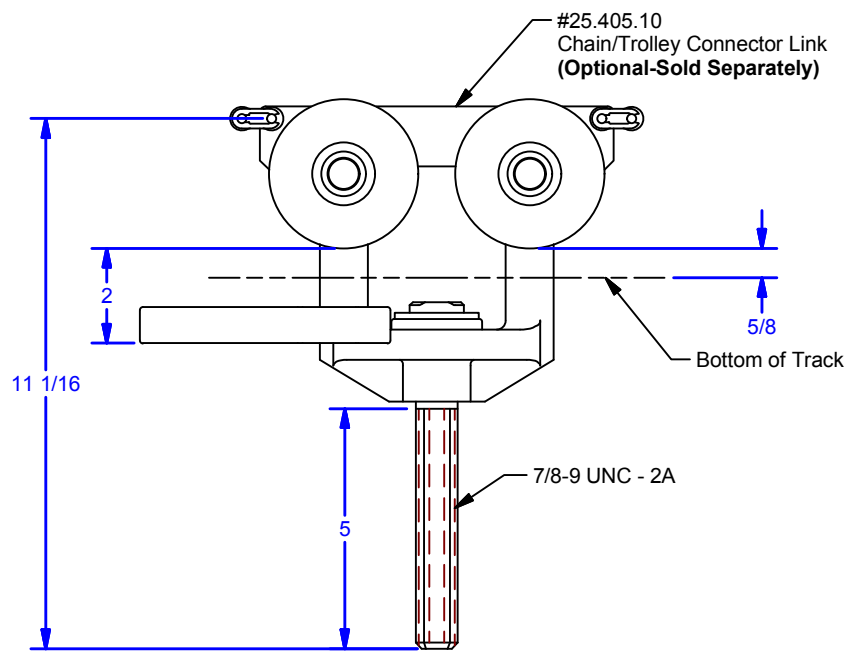

**Indicate Handing:**  
25.405L-RH1

Lead Drive Trolley with R.H. Limit Switch on Concave Wheel as shown.

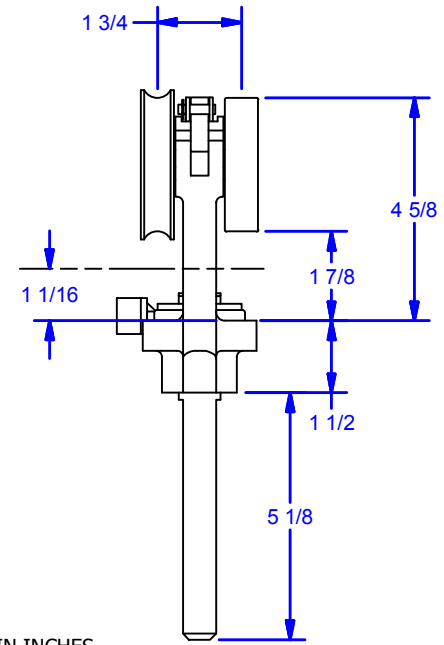

**ALL DIMENSIONS IN INCHES**

THE INFORMATION CONTAINED IN THIS DRAWING IS THE SOLE PROPERTY OF CROWN INDUSTRIAL. ANY REPRODUCTION IN PART OR AS A WHOLE WITHOUT THE WRITTEN PERMISSION OF CROWN INDUSTRIAL IS PROHIBITED.

ID #: 405P764-1

STOCK PART #: 25.405L-RH1

MATERIAL: Welded Steel Mild

DESCRIPTION: Lead Drive Trolley @ Concave Wheel w/ LS Arm (R.H. Limit Switch)

FINISH: # PCS: REV:



**CROWN INDUSTRIAL**  
So. San Francisco, Ca  
(650) 952-5150  
www.crown-industrial.com

4

3

2

1

