

Varies, Dependent on Door Thickness

1/2" Lag Screw, By Others

Gusset Optional, dependent on Door Weight

#43x22 By-Passing Bracket

1/2" Fastener Included to Secure Track to 43x22 Bracket

#43WS Wall Spacer (Must attach to Solid Blocking)

#43WS Wall Spacer (Attaches Track to 43x22 Bracket)

10 15/16

15/16

2

6 1/2

6 1/2

1 1/2

3/8 Min. Clear Between Face of Door & Wall

Door Thickness (INDICATE)

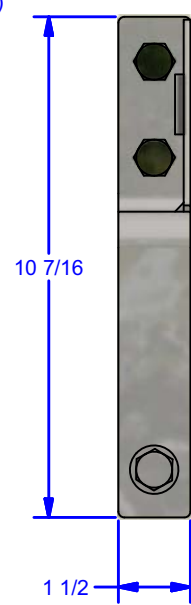

Elevation View of 43x22 Bracket

ALL DIMENSIONS IN INCHES

THE INFORMATION CONTAINED IN THIS DRAWING IS THE SOLE PROPERTY OF CROWN INDUSTRIAL. ANY REPRODUCTION IN PART OR AS A WHOLE WITHOUT THE WRITTEN PERMISSION OF CROWN INDUSTRIAL IS PROHIBITED.	ID #:	STOCK PART #:
	0002742-01	43x22
DESCRIPTION:	MATERIAL:	
43 By-Passing Bracket for Flat Track Sliding Door Hardware		
FINISH:	# PCS:	REV:

CROWN INDUSTRIAL
So. San Francisco, Ca
(650) 952-5150
www.crown-industrial.com

DWG #: 0002737
DRAWN:BCM 10/9/2018
SHEET #4
File: 0002737.idw