

4

3

2

1

D

D

C

C

B

B

A

A

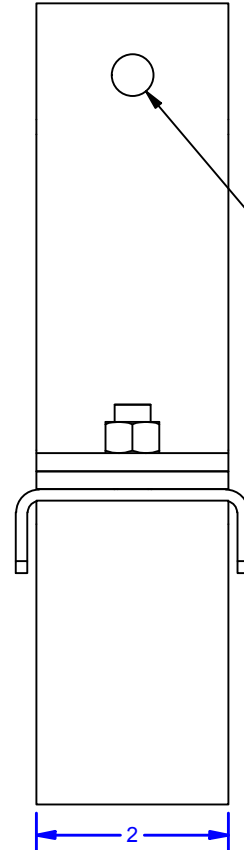
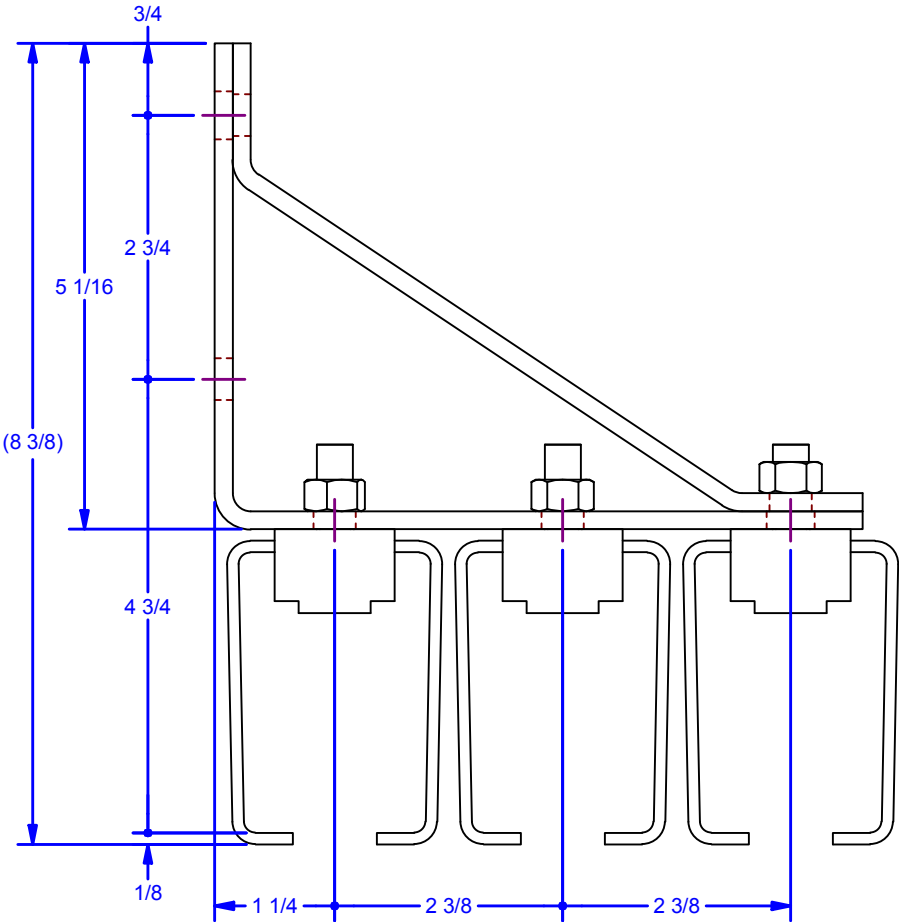
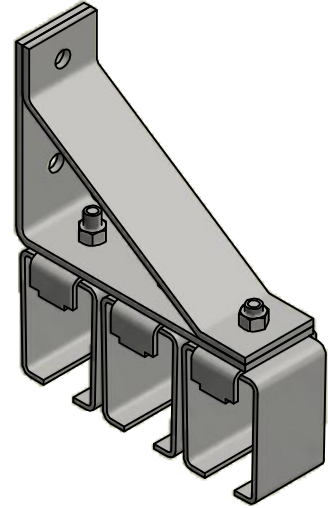
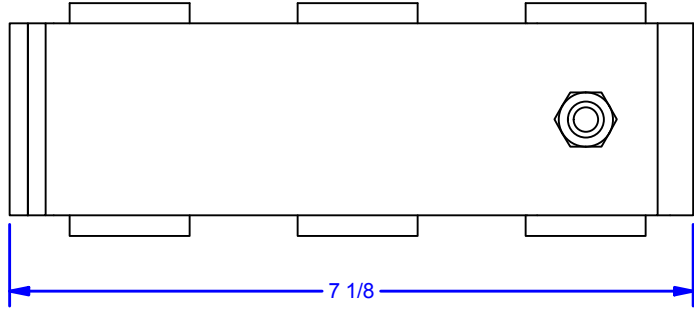

2X Ø7/16 THRU
For 3/8 Fasteners (By Others)

Note:
30" Centers Maximum Brack Spacing up to 400lb Capacity
For 1-3/4" Thick Doors, Standard Configuration

Avail. Finishes:
Galvanized (Stocked)
Powder Coat Black
Powder Coat Pebble Tan
304 Stainless Steel w. #2B Mill Finish
304 Stainless Steel w #4 Brushed Finish

DWG #: 4x33
DRAWN:BCM 2/14/2013
SHEET #3
File: 0001376.idw

ALL DIMENSIONS IN INCHES

THE INFORMATION CONTAINED IN THIS DRAWING IS THE SOLE PROPERTY OF CROWN INDUSTRIAL. ANY REPRODUCTION IN PART OR AS A WHOLE WITHOUT THE WRITTEN PERMISSION OF CROWN INDUSTRIAL IS PROHIBITED.	ID #: 0001376-01-07	STOCK PART #: 4x339
DESCRIPTION: Triple Joint Bracket (1-3/4" Thick Door, Std.)	MATERIAL:	
FINISH:	# PCS:	REV:



CROWN INDUSTRIAL
So. San Francisco, Ca
(650) 952-5150
www.crown-industrial.com

4

3

2

1



4

3

2

1

D

D

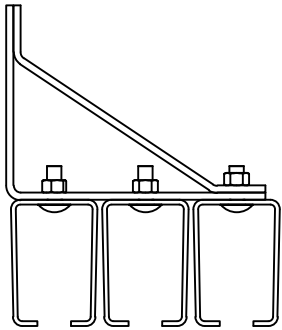

4x33

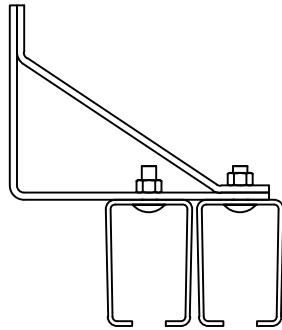

4x33-1

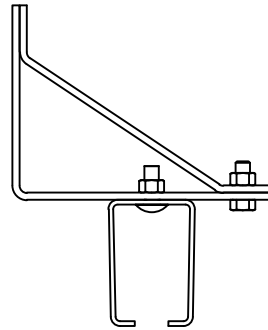

4x33-13

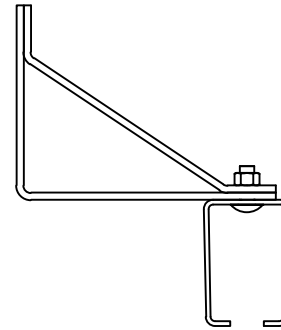

4x33-12

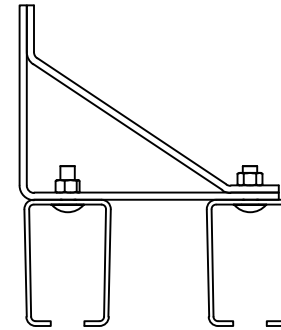

4x33-2

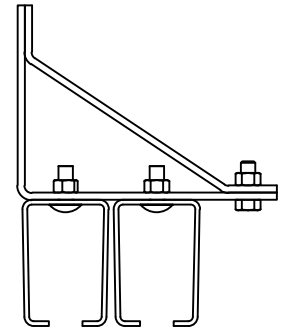

4x33-3

C

C

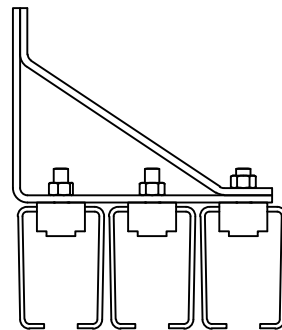

4x339

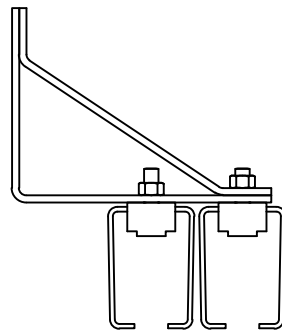

4x339-1

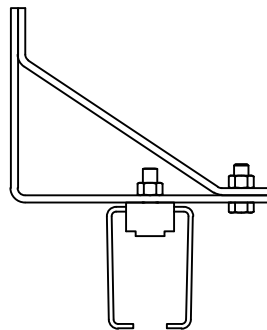

4x339-13

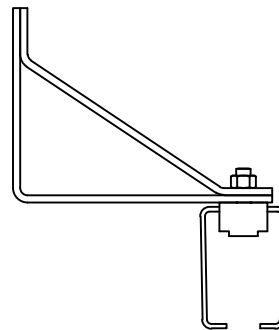

4x339-12

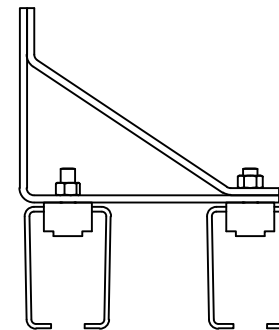

4x339-2

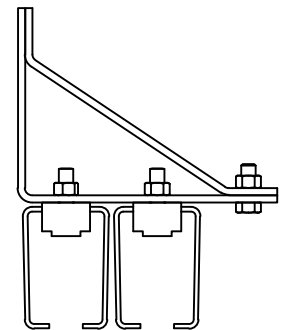

4x339-3

B

B

A

A

DWG #: 4x33
DRAWN:BCM 2/14/2013
SHEET #2
File: 0001376.idw

ALL DIMENSIONS IN INCHES

THE INFORMATION CONTAINED IN THIS DRAWING IS THE SOLE PROPERTY OF CROWN INDUSTRIAL. ANY REPRODUCTION IN PART OR AS A WHOLE WITHOUT THE WRITTEN PERMISSION OF CROWN INDUSTRIAL IS PROHIBITED.

ID #: 0001376-01-01

STOCK PART #: 4x33

MATERIAL:

DESCRIPTION:

Triple Center Bracket (1-3/4" Thick Door, Std.)

FINISH:

PCS. REV:



CROWN INDUSTRIAL

So. San Francisco, Ca
(650) 952-5150

www.crown-industrial.com

4

3

2

1

