

Hinge Measurements
 Indicate: Hinges measured from top of **DOOR** or **FRAME**
 to top of hinge

of Openings: _____
 Hinge Size: _____
 Number of Hinges: _____
 Hinge Backset: _____
 Fire Rating: _____
 Latch Type: _____
 Latch Backset: _____
 Strike Height: _____
 (Measured from top of door/frame to centerline of strike deadbolt)
 Height of Strike Plate: _____
 Lock Backset: _____
 Vision Lite: Yes/ No
 Glass Type: _____
 Frame Type: _____
 Frame Metal Guage: _____
 Door Type: _____
 Astragal: Active / Inactive
 Astragal Location: Interior / Exterior
 Wall Thickness: _____
 Wall Construction: _____
 Threshold: Yes / No
 Frame Casing: Yes / No
 (finishes frame to wall)

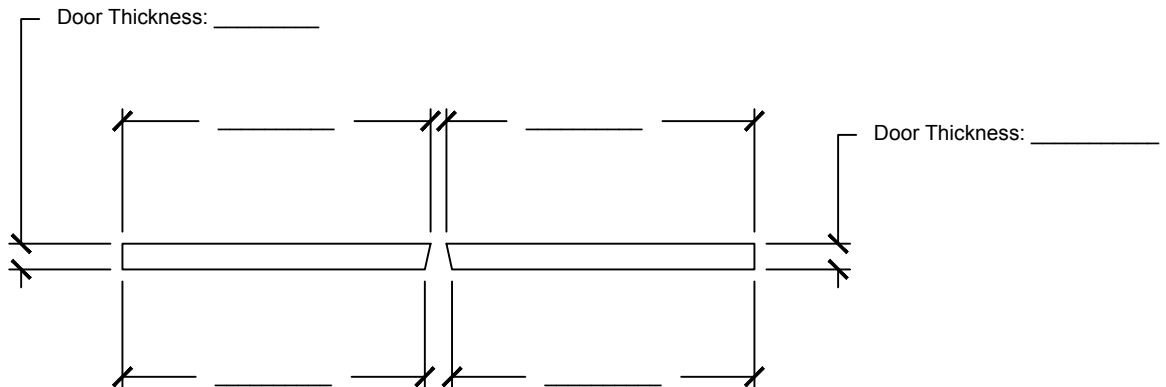

 DWG #----
 DESCRIP: ----
 DRAWN:BCM ---- REV:-----
 SCALE: 1' = 1'-0"
 SHEET # 1

FILE:c:\vault\workspace\designs\door\hollowmetal\hmdoormeasurements

THE INFORMATION CONTAINED IN THIS DRAWING IS THE SOLE PROPERTY OF CROWN INDUSTRIAL. ANY REPRODUCTION IN PART OR AS A WHOLE WITHOUT WRITTEN PERMISSION OF CROWN INDUSTRIAL IS PROHIBITED.



CROWN INDUSTRIAL

So. San Francisco, Ca
 (650) 952-5150

www.crown-industrial.com

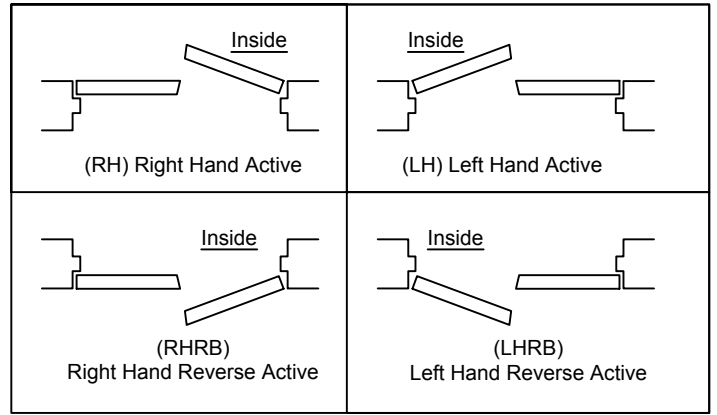
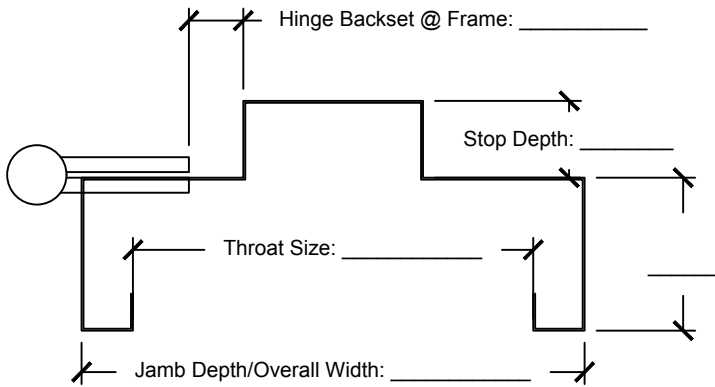

Door Handing (Indicate)

Hinge/Frame Section Details

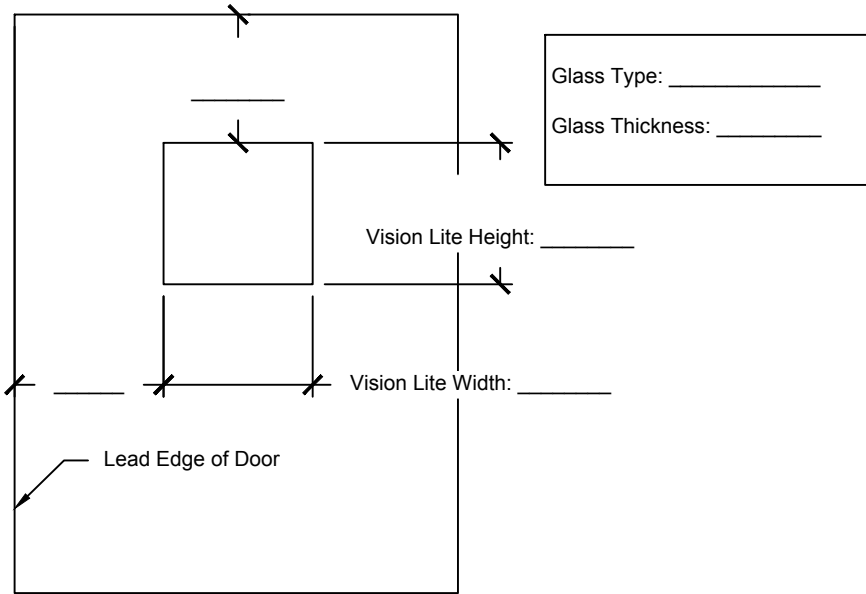

Vision Lite Details

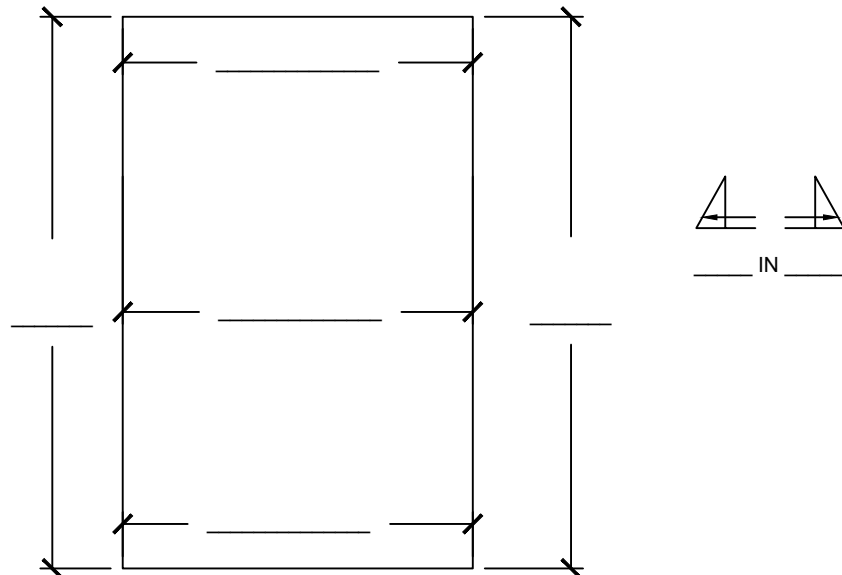

OPENING SIZE
Indicate: **ROUGH** or **FINISHED** opening

 DWG #----
 DESCIP: ----
 DRAWN:BCM ---- REV:-----
 SCALE: 1' = 1'-0"
 SHEET # 2

FILE:c:\vault\workspace\designs\door\hollowmetal\hmdoor\measurements

THE INFORMATION CONTAINED IN THIS DRAWING IS THE SOLE PROPERTY OF CROWN INDUSTRIAL. ANY REPRODUCTION IN PART OR AS A WHOLE WITHOUT WRITTEN PERMISSION OF CROWN INDUSTRIAL IS PROHIBITED.



CROWN INDUSTRIAL

So. San Francisco, Ca
(650) 952-5150

www.crown-industrial.com



CROWN INDUSTRIAL SUPPLY

Door Hardware, Doors, Operators and Complete Systems

Hollow Metal Doors

Typical Door Sections

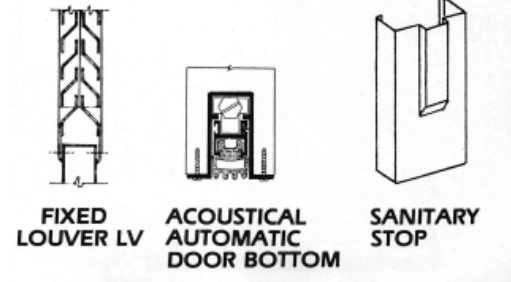
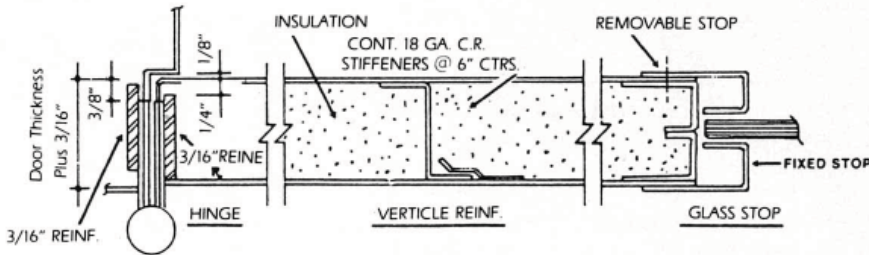

Typical Door Types

HOLLOW METAL

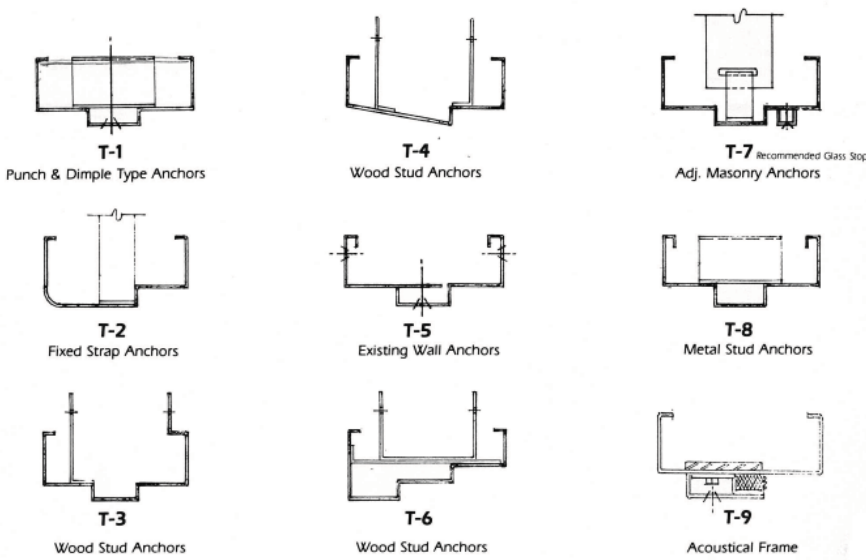
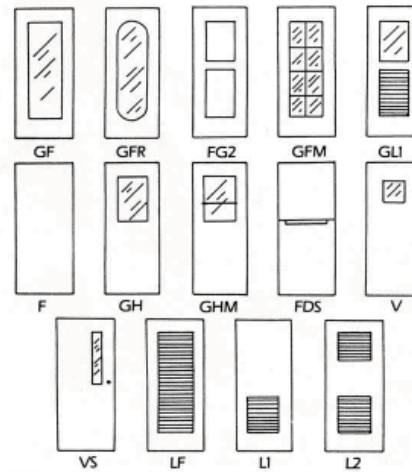

14 Gauge Frame Types