

4

3

2

1

D

D

C

C

B

B

A

A

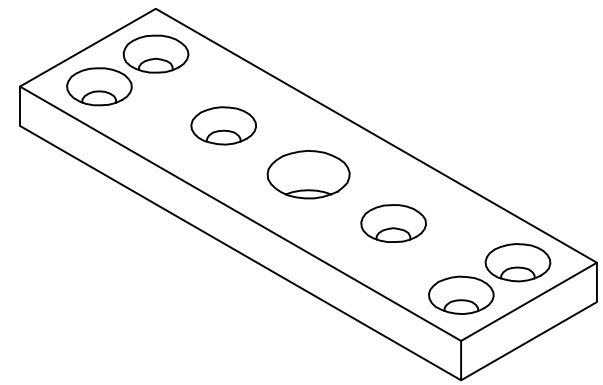
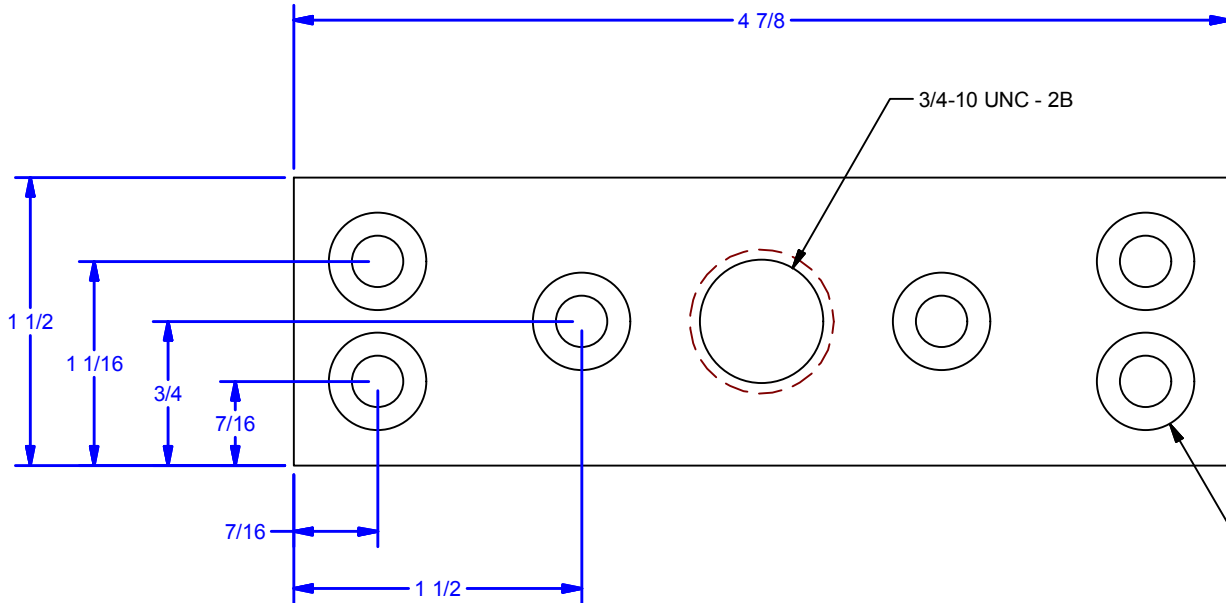

1-3/4" Minimum Door Thickness

- Available Finishes:**
- 2321.00013 - Powder Coat Pebble Tan
  - 2321.00013SC - Powder Coat Black
  - 2321.00013ZC - Clear Zinc
  - 2321.00013SS - 304 Stainless Steel, 2B Mill Finish

ALL DIMENSIONS IN INCHES

THE INFORMATION CONTAINED IN THIS DRAWING IS THE SOLE PROPERTY OF CROWN INDUSTRIAL. ANY REPRODUCTION IN PART OR AS A WHOLE WITHOUT THE WRITTEN PERMISSION OF CROWN INDUSTRIAL IS PROHIBITED.	PART #:	STOCK #:
	0001674	2321.00013
DESCRIPTION:	MATERIAL:	
Top Plate, for 1-3/4" Min. Thick Door	Steel, Mild	
FINISH:	# PCS:	REV:



**CROWN INDUSTRIAL**  
 So. San Francisco, Ca  
 (650) 952-5150  
 www.crown-industrial.com

DWG #: 0001674  
 DRAWN:BCM 6/17/2014  
 SHEET #1  
 File: 0001674.idw

4

3

2

1

